



CAPITAL
HIGHSTREET
BHIWADI Shops • Offices • Studio Apartments

Live, Eat, Play, Work
All Under One Roof



R-Tech Group Pvt. Ltd.
Building No. 44, 1st Floor, Sector - 44,
Gurgaon - 122002, Haryana
E-mail: info@rtechgroup.co.in
Web: www.rtechgroup.co.in

This project is
Designed by



Disclaimer :- The visual shown and represented herein are on conceptual basis only, and shall have no bearing, in any manner, of booking to be made in this Project and the Developer reserve all rights, in this regard. This Brochure is not a legal document.

CAPITAL
HIGHSTREET
BHIWADI Shops • Offices • Studio Apartments



About Highstreet

Capital Highstreet is all about revolutionizing the way we live, eat, play and work. The architecture is a subtle reminder of the grandeur of the Egyptian era and stands tall against the backdrop of crystal clear skies and a lush green environment. Rest assured, once inside, it's a whole new experience. This is where attention to details comes to life. There's a serenity of luxury here. A shopping structure for some, while a portal into a realm of tranquility for others.

Spread over a plot size of 21,000 sq. mtr. (5.25 acres), Capital Highstreet has a built-up area of over 1 Million sq. ft. divided over 10 floors and two-level basement parking. This 110 ft. standing high tower boasts of a 40,000 sq. ft. large central atrium with four floors dedicated to Retail, three floors to Offices and three floors to Service Suites.

A Place **BEYOND**
IMAGINATION

About Location

Located in Bhiwadi on NH - 71B, Capital Highstreet is among the new commercial, retail and residential projects emerging in this ever-expanding township. Not only does Capital Highstreet bring luxury & comfort to the people of Bhiwadi, but also brings lifestyle along with it.

Bhiwadi is a fast developing industrial town; located on the periphery of Delhi NCR, it is considered an extension of South of Gurgaon. Today, Bhiwadi has emerged as a futuristic city, unfolding endless opportunities to entrepreneurs, professionals and upwardly mobile people to nurture their dreams. It is replete with a slew of MNC's, world class industries and state-of-the-art residential complexes. It is a hub of automobile and apparel industry with world-class technology and infrastructure.



I have lots of **BAGS**
full of **SHOPPING**



Experience Shopping

Capital Highstreet offers a unique shopping experience that was unknown to the township till now. Friends and family can enjoy shopping at this high-end shopping mall that offers you a variety of international brands for everyone, ranging from regular commodities to luxury products. And from designer garments to utilities....

Capital Highstreet will showcase some of the best brands in the retail segment and will be comparable to some of the best shopping malls in the country. The showrooms are planned to provide wide open spaces and show windows for ease of shopping.

I Want to **SHOP**
all day **LONG**

CAPITAL
HIGHSTREET
BHIWADI Shops • Offices • Studio Apartments

Experience Office

Having an office address at Capital Highstreet in the midst of retail and entertainment areas is a unique experience by itself. Large open spaces, well lit alleys, entertainment areas, access to food-courts and a world-class work environment are some of the highlights of Capital Highstreet. The surroundings provide an energy that will keep the people refreshed and rebooted all day long.

Besides this, Capital Highstreet offers a premium address to all the international and local organisations that wish to relocate here.



WORK was never
so Much **FUN**

Enough **SPACE**
for all fun



Experience Home

Capital Highstreet offers service suites that will take your breath away. Large spaces, liberal amenities, premium specifications and much more that makes for your fine stay at this address. The suites at Capital Highstreet have well designed interiors set to inspire all your senses. Lets raise a toast to your prosperous life here, to come and relish the brew of luxury.



Experience Food

The food-court at Capital Highstreet is designed to attract a large number of visitors, considering the catchment of offices and residential areas surrounded it. Being one-of-a-kind food-court in the vicinity, it promises to gather a lot of footfalls from in and around Bhiwadi.

Busy office executives will be seen entertaining guests, employees catching a bite over lunch and the shoppers will be seen relaxing and gluttoning after a tiring day full of shopping. The food-court will offer a variety to all depending on their tastes and moods. From high-end coffee shops to regional and global cuisines!

Live, Eat, Play, Work
All under **ONE ROOF**

I'll have a cup of **CAPPUCCINO**
with **CHOCOLATE COOKIES**



Highlights

LOCATION

Strategically located on NH - 71 B, Bhiwadi
3 side wide road

AREA

Plot Area: 21000 sq. mtr. (5.25 Acres)
Saleable Area: 775,000 sq. ft.
Built Up Area: 1 million sq. ft.
Huge atrium 40,000 sq. ft.
Front plaza 34,500 sq. ft.

FEATURES

4 Floors for retails
Office Floors
Service Suites
Gym & Spa
Restaurants
Food Court

ECONOMY

Low maintenance cost

CONVENIENCE

100% Power Back-up
High speed Passengers & Service Lift
Escalator
Wide Corridors
2 Level Basement Parking

SECURITY

Earthquake resistant RCC frames structure
24 hrs security
Detailed CCTV controlled security system
High quality fire fighting & fire alarm system



Capital Galleria, Bhiwadi



Promoters

The R-Tech name is synonymous to trust, quality, comfort and reliability. We believe in combining the strength of our experiences with the resources at hand so that we can cater to the dynamic needs of our customers.

R-Tech pioneered the concept of organized retail in Bhiwadi and Alwar by creating the world class infrastructure.

From start to finish it took two and a half years to complete Capital Mall, Bhiwadi and Cross Point Mall, Alwar which is a record. Both are running successfully for the last one year with all the top class retail brands converging therein with world class products and services. Even another retail and office Project Capital Galleria is under construction at Bhiwadi only.

Our Malls have become the ultimate destination for the seekers of high lifestyle shopping and entertainment.

R-Tech is a trendsetter and has created milestones to be chased by others in the times to come.

Capital Mall Nominated for
India's Best Commercial & Retail Shopping Mall
(Non - Metro) by
CREDAI Real Estate Awards 2012

Pioneered in Organized Retail



Main Entry to Capital Highstreet

CAPITAL 
HIGHSTREET
BHIWADI Shops • Offices • Studio Apartments

Floor Plans

Lower Ground Floor

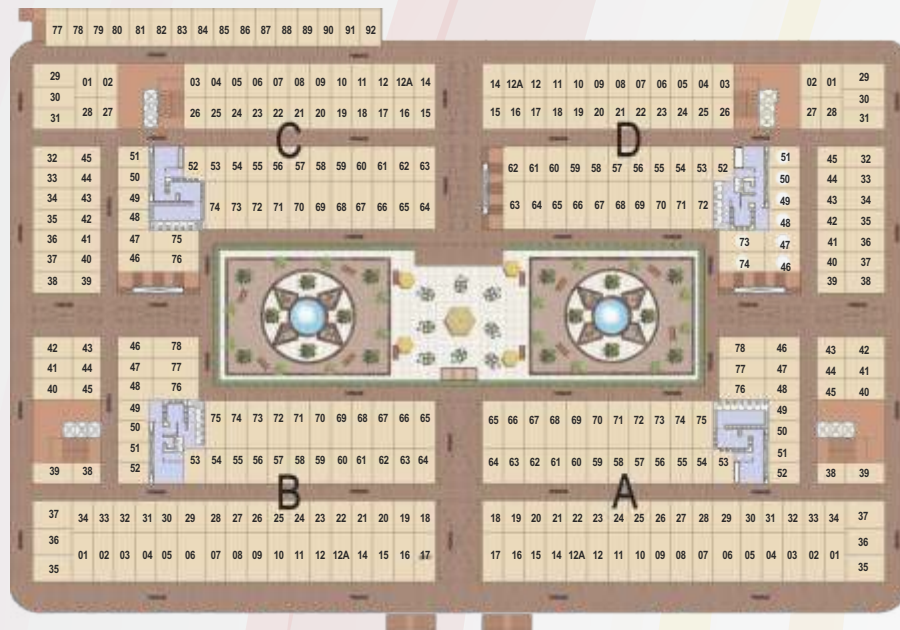

First Floor



Third Floor

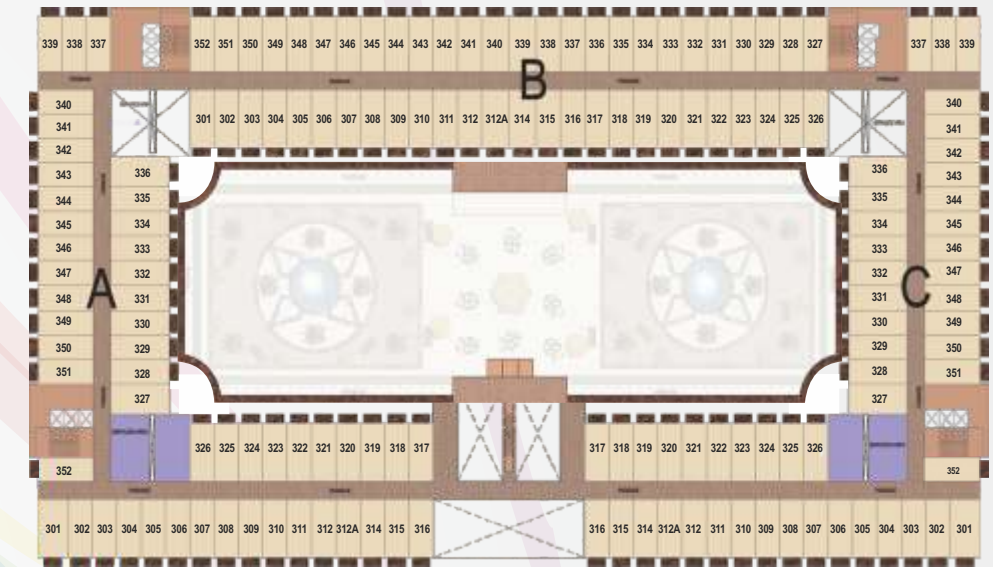

Ground Floor



Second Floor

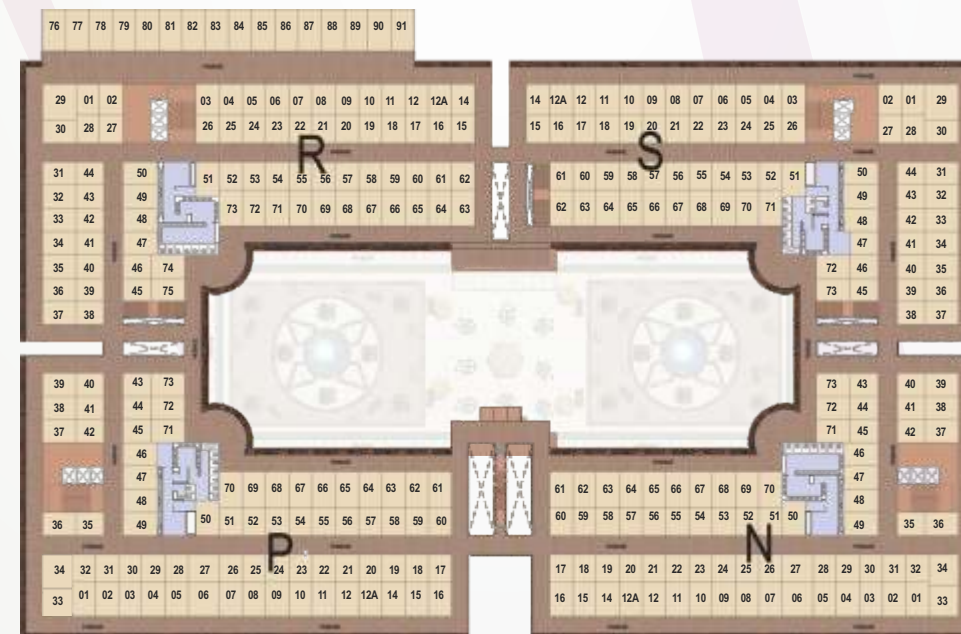

Fourth Floor

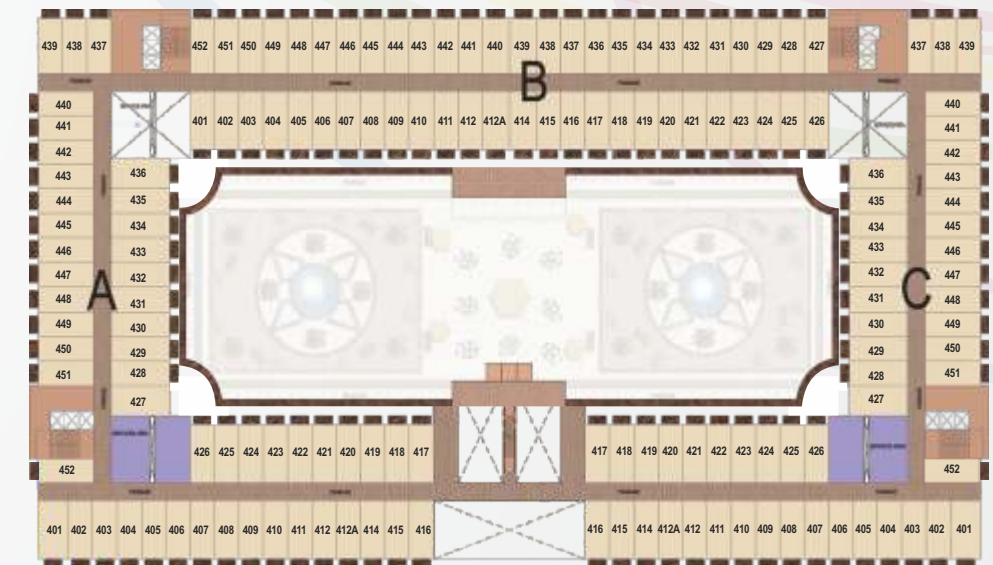

Zest Of Creating A New World...
...Joy Of Deeds Well Done



More than
17,000
Satisfied Customers...
and counting

OUR LANDMARK PROJECTS

<p>Operational</p> <p>R>TECH CAPITAL MALL BHIWADI</p>	<p>Operational</p> <p>R>TECH CROSS POINT MALL ALWAR</p>	<p>Operational</p> <p>CAPITAL GALLERIA BHIWADI <i>Retail cum Office</i></p>	<p>Operational</p> <p>CAPITAL HIGHSTREET BHIWADI <i>Shops • Offices • Studio Apartments</i></p>	<p>Operational</p> <p>CAPITAL HIGHWAY ARCADE BEHROR</p>	<p>Delivered</p> <p>CAPITAL GREENS BHIWADI RERA REGN. NO: RAJ/P/2017/075</p>
<p>Operational</p> <p>CAPITAL GALLERIA ALWAR <i>Retail • Offices • Multiplex • Studio Apartments</i></p> <p>RERA REGN NO: RAJ/P/2017/073</p>	<p>Operational</p> <p>CAPITAL GALLERIA NEEMRANA <i>Retail • Food Courts • Studio Apartment</i></p> <p>RERA REGN NO: RAJ/P/2017/074</p>	<p>Under Construction</p> <p>R>TECH CAPITAL HIGHSTREET JAIPUR</p> <p>RERA REGN NO: RAJ/P/2017/045</p>	<p>Under Construction</p> <p>CAPITAL GALLERIA SIRSI ROAD, VAISHALI NAGAR, JAIPUR A PROJECT OF R>TECH & MNS</p> <p>RERA REGN NO: RAJ/P/2017/153</p>	<p>Under Construction</p> <p>GREEN PARK CHIKANI, ALWAR</p> <p>RERA REGN NO: RAJ/P/2017/034</p>	<p>Under Construction</p> <p>R>TECH CAPITAL HIGHSTREET BIKANER</p> <p>RERA REGN NO: RAJ/P/2018/612</p>
<p>Under Construction</p> <p>R>TECH CAPITAL ARCADIA MAIN ALWAR BY PASS ROAD • BHIWADI</p> <p>RERA REGN. NO: RAJ/P/2018/701</p>	<p>Under Construction</p> <p>R>TECH CAPITAL HOMES BEAWAR</p> <p>RERA REGN. NO: RAJ/P/2018/616</p>	<p>Under Construction</p> <p>R>TECH CAPITAL HIGHSTREET BEAWAR</p> <p>RERA REGN. NO: RAJ/P/2018/803</p>	<p>Excavations Start</p> <p>R>TECH CAPITAL HIGHSTREET KOTA</p> <p>RERA REGN. NO: RAJ/P/2019/992</p>	<p>Coming Soon</p> <p>R>TECH CAPITAL MEGAPOLIS JODHPUR</p>	<p>R>TECH RETAIL 75 STORES ALREADY OPERATIONAL</p>





Ongoing R-Tech projects are registered with RERA Authority and documents can be verified at www.rera.rajasthan.gov.in

ALWAR • BEAWAR • BEHROR • BHIWADI • BIKANER • JAIPUR • JODHPUR • KOTA • NEEMRANA

COMING SOON IN - UDAIPUR • BHILWARA

COMMERCIAL • RESIDENTIAL • TOWNSHIPS • RETAIL

ASSOCIATED BRANDS

Fifth Floor

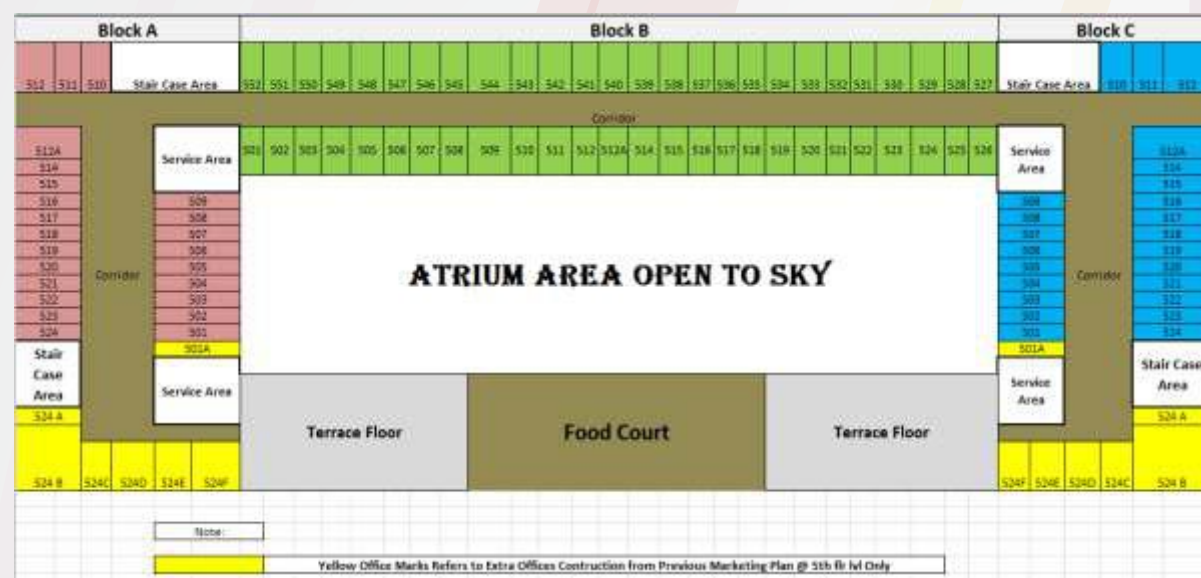

Seventh Floor

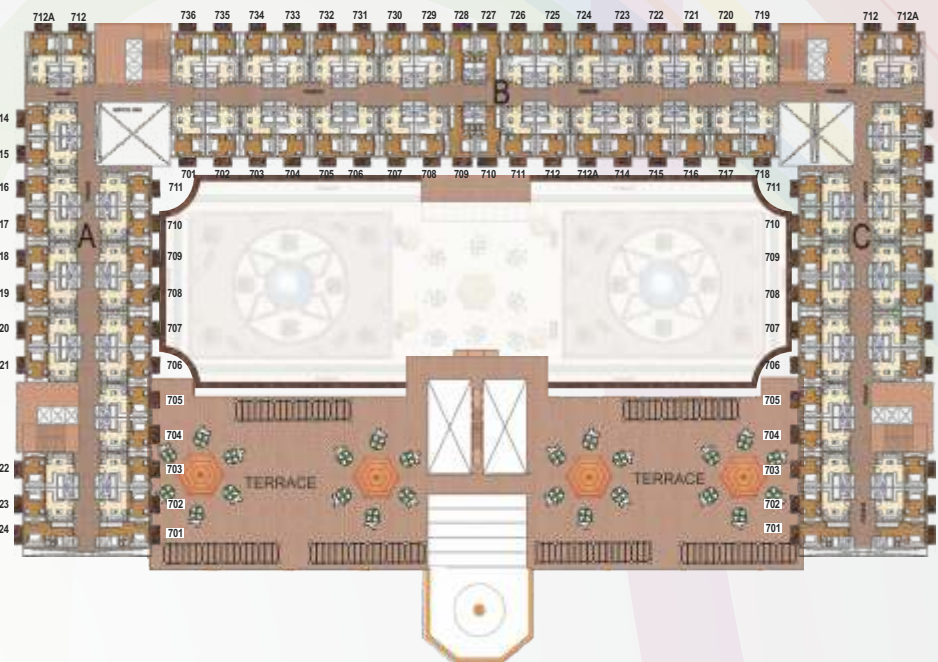

Sixth Floor

