

THE NEW AGE LIFESTYLE



Site Office: Plot No. CP1-231, Apparel Park, RIICO Industrial Area, Main Mahal Road, Jagatpura, Jaipur - 302017

Registered Office: Shop No. FF29, First Floor, 812, CP4, Capital Mall, RIICO, Industrial Area, Bhiwadi, Rajasthan-301019

Corporate Office: Plot No. 3(A), RIICO Indl. Area, Kanakpura, Sirsi Road, Vaishali Nagar, Jaipur, Rajasthan-302034

Web.: www.rtechgroup.co.in

Follow us 

Disclaimer: The visual representation shown in this brochure are purely conceptual and for reference only and does not resemble any building structure and shall have no bearing, in any manner of booking made in this project and the developer reserve all rights, in this regard. This brochure is not a legal document.

R>TECH
CAPITAL
HIGHSTREET
JAIPUR

RERA Registration No.: RAJ/P/2017/045

Disclaimer: The visual representation shown in this brochure are purely conceptual and for reference only and does not resemble any building structure and shall have no bearing, in any manner of booking made in this project and the developer reserve all rights, in this regard. This brochure is not a legal document.



BUILDING ON SUCCESS

About R-Tech Group

Soaring on a growth path with proven success & leadership

R-Tech is one of the most rapidly growing business conglomerate with diversified interests across Commercial, Residential, Townships & Retail segments of the real estate arena. After having established in the year 2007, within a short span of 13 years the R-Tech Group has today gone on to become a multifaceted organization posting an impressive growth rate & turnover. Growing at an average rate of 25% year on year, the company has today a portfolio of projects worth over INR 5000 crore.

The Group has mega stakes in the real estate sector where it has created world-class infrastructure spread across 100 lac square feet area and has plans to add more in the coming years. R-Tech continues to grow and chart new territories under the able stewardship of the Group's Managing Director Mr. Rajesh Kumar Yadav, Mr. Rajinder Kumar Yadav and it's Board of Directors.



200ft. Wide Road
3 Side Open
Marvelous Architecture
All Shops Located Prominently
Plot Area: 1,27,984 sq.ft.
Built-Up Area: 4,57,638 sq.ft.
Frontage: 426 ft.
Expansive Atrium



FEATURES

- 4 Retail Floors
- Offices
- 4 Screen Multiplex
- Foodcourt
- Gym & Retail Kiosks
- Rooftop Café
- Gaming Zone

ECONOMY

- Low Maintenance Cost
- Open Highstreet Market



CONVENIENCE

- 2 Level Basement Parking
- High Speed Passenger and Service Lifts
- Escalators
- Wide Corridor
- Power Backup



SECURITY

- Detailed CCTV Controlled Security System
- 24 hrs. Security
- Earthquake Resistant RCC Frame Structure
- High Quality Fire Fighting & Fire Alarm System



CELEBRATE LIFESTYLE

R>TECH
CAPITAL
HIGHSTREET
JAIPUR

After numerous path-breaking retail masterpieces the R-Tech Group with its accrued and acquired experience, expertise and entrepreneurship, is all set to create yet another marvel in the world of commercial spaces in the region and celebrate lifestyle in its true sense.

Disclaimer: The visual representation shown in this brochure are purely conceptual and for reference only and does not resemble any building structure and shall have no bearing, in any manner of booking made in this project and the developer reserve all rights, in this regard. This brochure is not a legal document.



FLAVOR
INFUSION



FAMILY
ENTERTAINMENT



SHOPPING
EXPERIENCE



ULTIMATE LOCATION

R-Tech Capital Highstreet has a great location which is well connected to all the major parts of the city giving it an edge over any other recent commercial development in the city of Jaipur

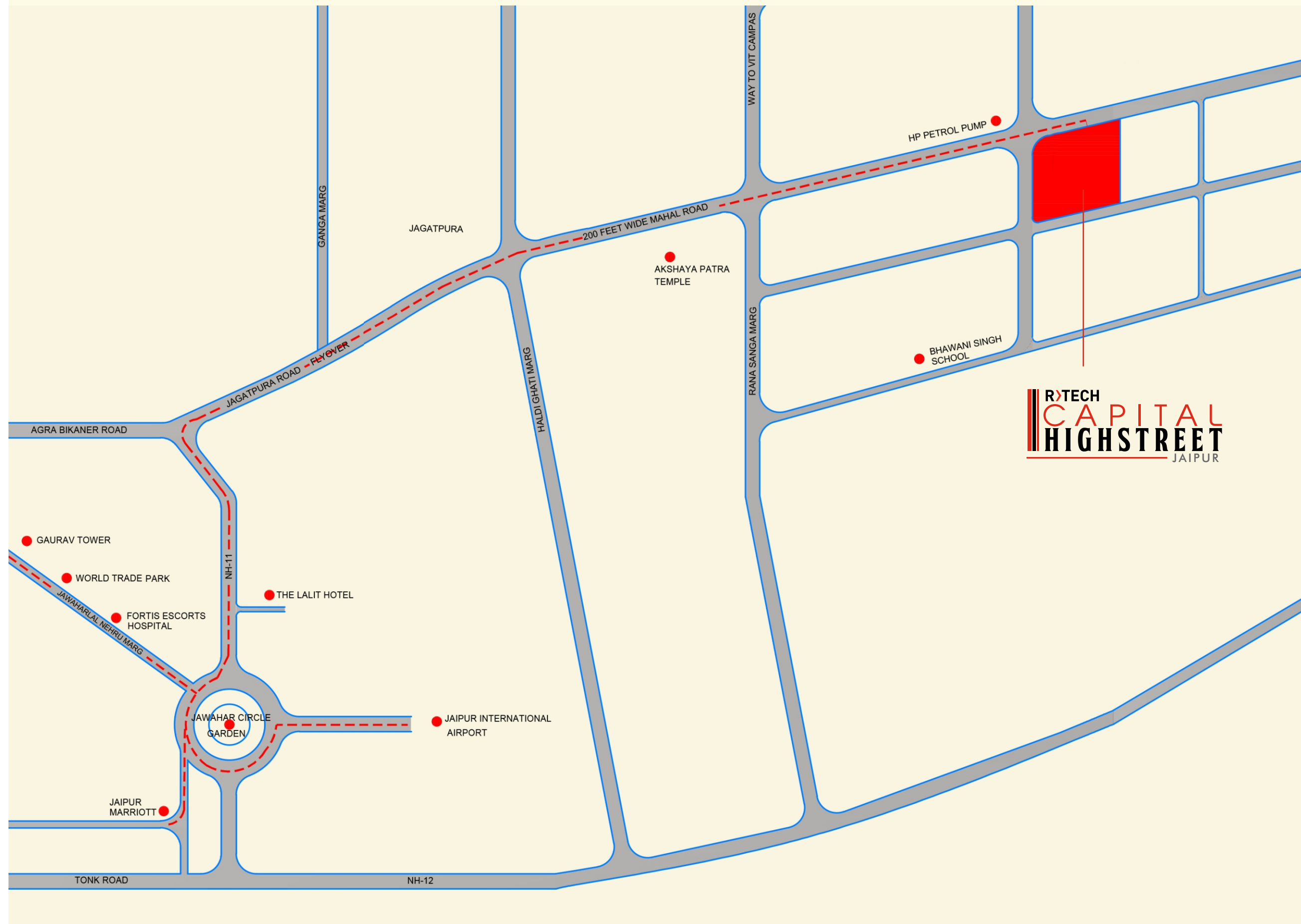

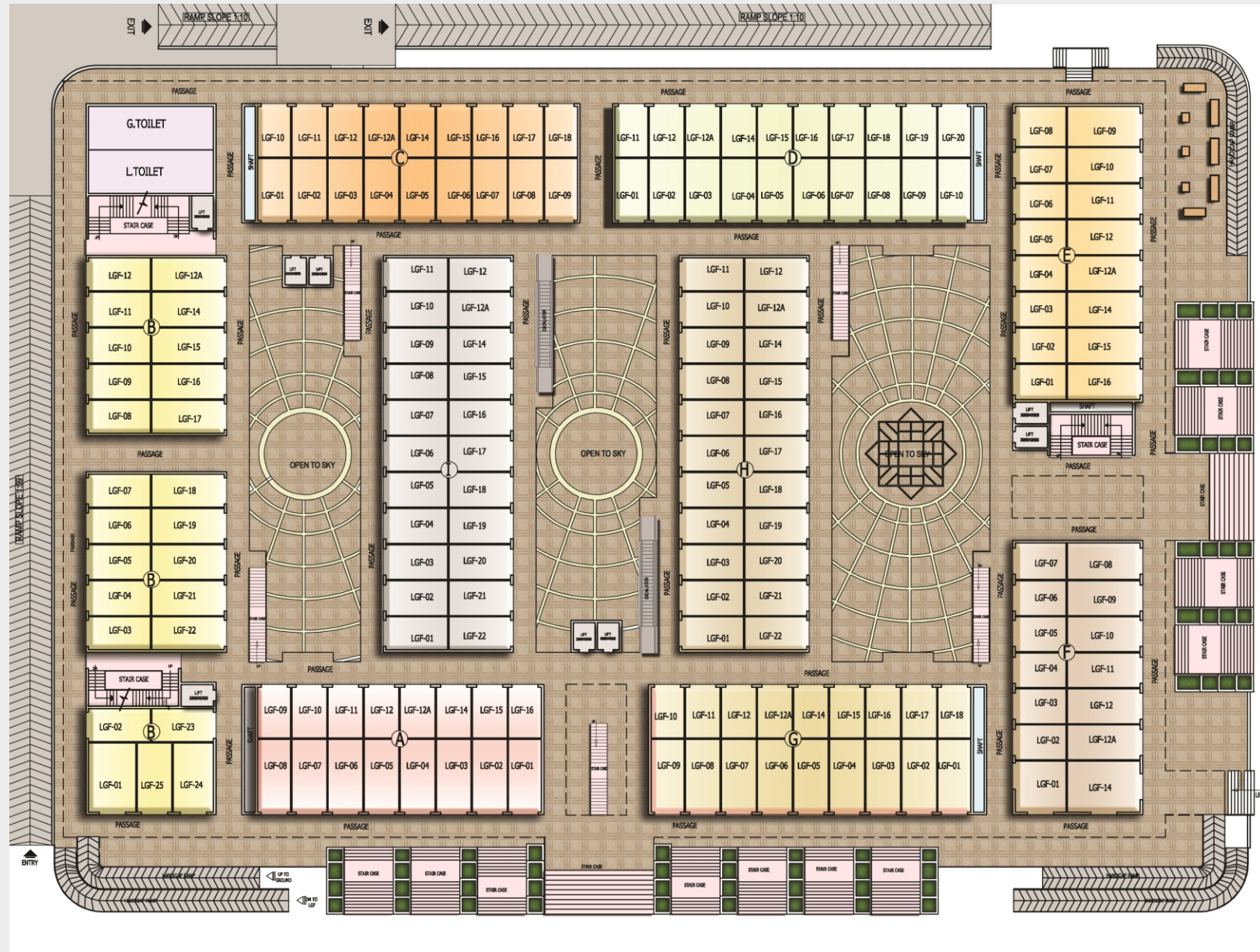

LOWER GROUND FLOOR



GROUND FLOOR



FIRST FLOOR



SECOND FLOOR



THIRD FLOOR



FOURTH FLOOR

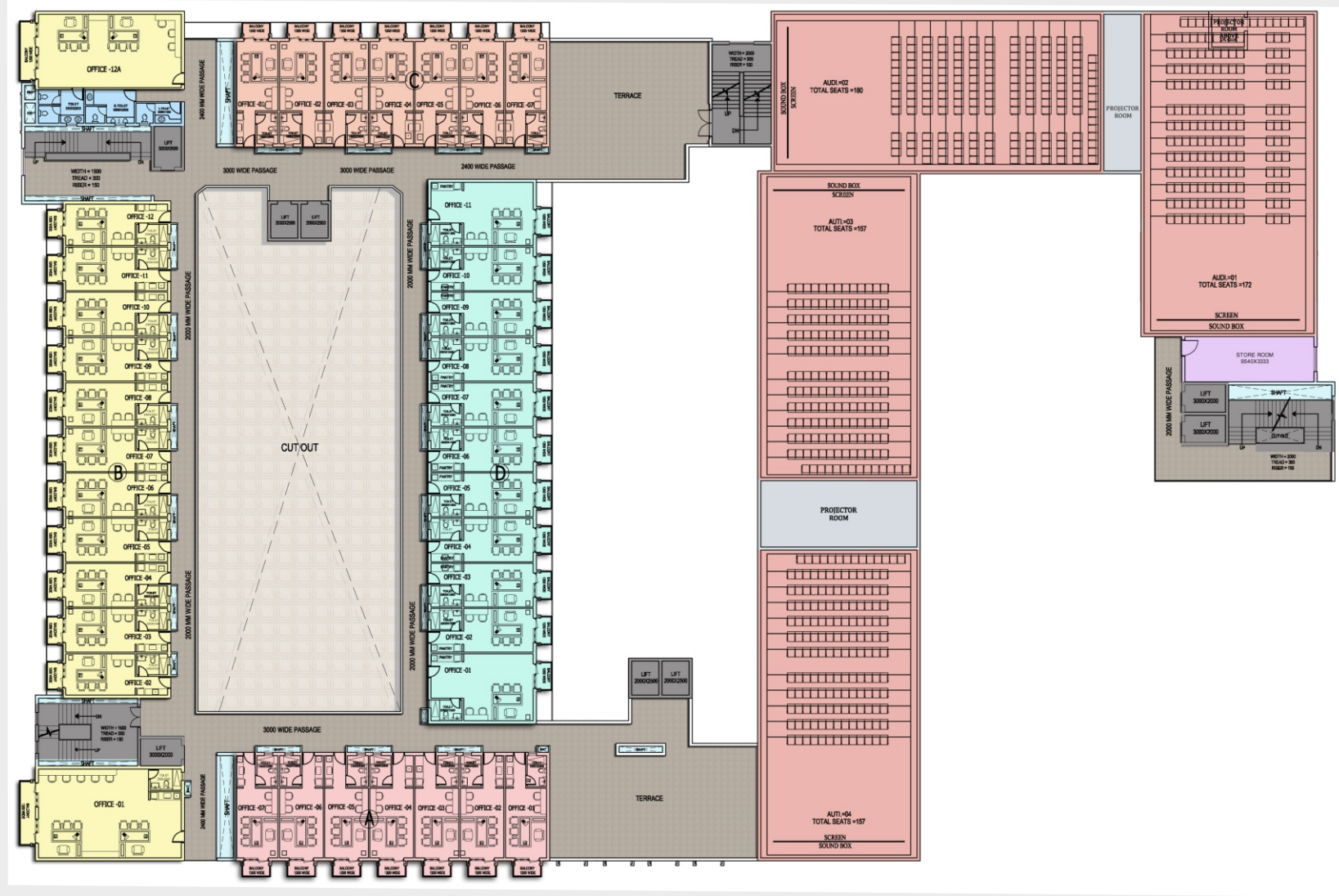

FIFTH FLOOR



SIXTH FLOOR



SEVENTH FLOOR

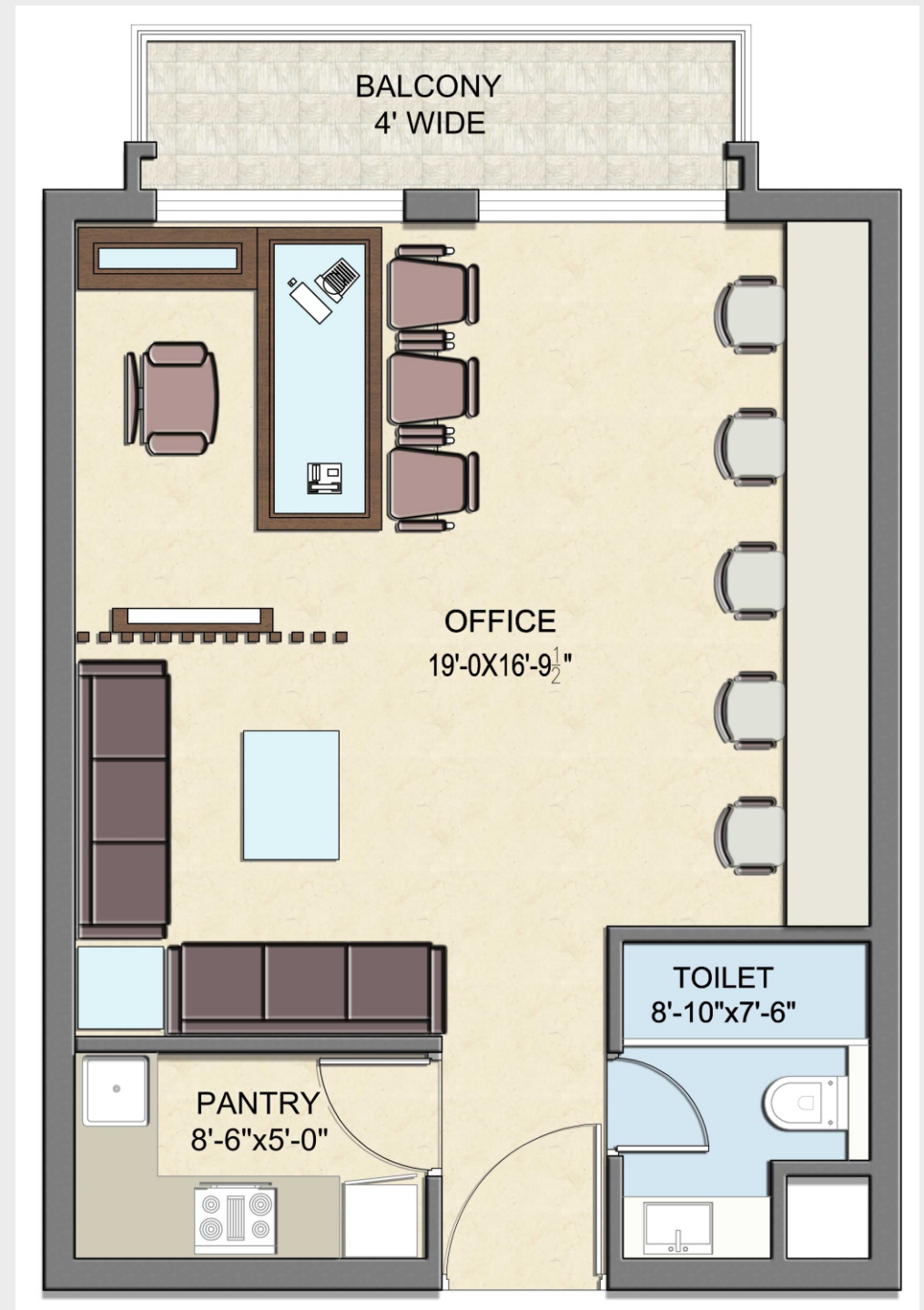
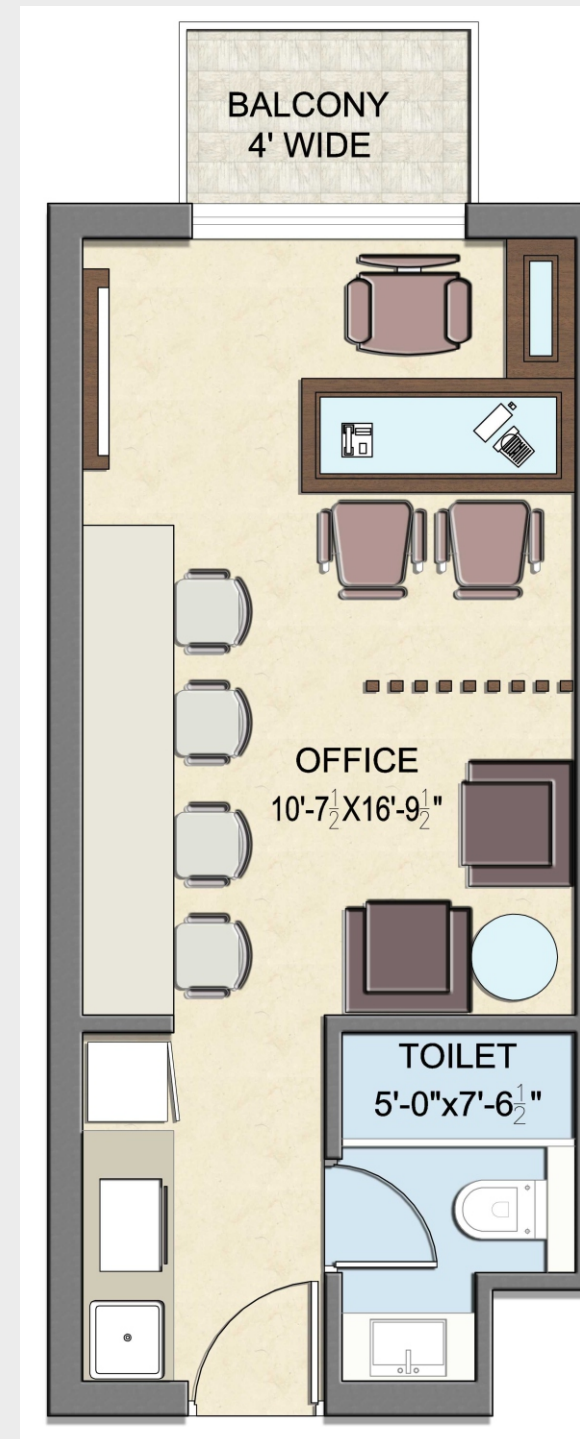

OFFICE LAYOUT



SPECIFICATIONS

COMMON AREA AND SPACE /UNIT	
COMMON AREA	
FLOORING	Combination of Kota Stone with combination Or Ceramic Tiles and/or Hard wearing Floor Material.
WALLS	Combinations of Cement Plaster with Suitable Paint
TOILETS	Marble/Granite/other suitable stones/Ceramic tiles Floor and Taps and Flushing system.
VERTICAL CIRCULATION	Lifts and Escalator
SHOP FRONT	SHOP/SPACE to be provided with M. S. Rolling Shutter
EXTERIOR	Combination of Exterior Paint or Texture Paint
POWER BACK-UP	Power Back-up
SHOPS	
FLOORING	Bare Concrete Floor/IPS
WALLS	PLAIN CEMENT PLASTER
POWER	Provided with prepaid dual metering system for main power as well as DG power supply at meter panel board in electrical shaft. From electrical shaft to shop/Space electrical cable & meter in the scope of client, as per load requirement.
FIRE DETECTION	One Set of sprinklers and Fire detection system connected to the common system of the building in conformity to Fire safety norms and smoke extraction system.

Disclaimer:-The specifications mentioned herein are tentative and can be changed at sole discretion of Developer, only



Disclaimer: The visual representation shown in this brochure are purely conceptual and for reference only and does not resemble any building structure and shall have no bearing, in any manner of booking made in this project and the developer reserve all rights, in this regard. This brochure is not a legal document.

THE R-TECH FOOTPRINT



All the Documents related to the said project are duly uploaded on www.rera.rajasthan.gov.in and the prospective buyer(s) can verify the same.



Zest of creating a new world.
Joy of deeds well done.

<p>Operational</p> <p>R>TECH CAPITAL MALL BHIWADI</p>	<p>Operational</p> <p>R>TECH CROSS POINT MALL ALWAR</p>	<p>Operational</p> <p>R>TECH CAPITAL GALLERIA BHIWADI Retail cum Office</p>	<p>Operational</p> <p>CAPITAL HIGHSTREET BHIWADI Shops • Offices • Studio Apartments</p>
<p>Operational</p> <p>CAPITAL HIGHWAY ARCADE BEHROR</p>	<p>Delivered</p> <p>CAPITAL GREENS BHIWADI RERA REGN. NO: RAJ/P/2017/075</p>	<p>Operational</p> <p>R>TECH CAPITAL GALLERIA ALWAR Retail • Offices • Multiplex • Studio Apartments RERA REGN NO:RAJ/P/2017/073</p>	<p>Operational</p> <p>R>TECH CAPITAL GALLERIA NEEMRANA Retail • Food Courts • Studio Apartment RERA REGN NO:RAJ/P/2017/074</p>
<p>Delivering Soon</p> <p>R>TECH CAPITAL HIGHSTREET JAIPUR RERA REGN NO:RAJ/P/2017/045</p>	<p>Under Construction</p> <p>CAPITAL GALLERIA SIRSI ROAD, VAISHALI NAGAR, JAIPUR A PROJECT OF R>TECH & MNS RERA REGN NO:RAJ/P/2017/153</p>	<p>Under Construction</p> <p>GREEN PARK CHIKANI, ALWAR RERA REGN NO:RAJ/P/2017/034</p>	<p>Under Construction</p> <p>R>TECH CAPITAL HIGHSTREET BIKANER RERA REGN NO:RAJ/P/2018/612</p>
<p>Under Construction</p> <p>R>TECH CAPITAL ARCADIA MAIN ALWAR BY PASS ROAD • BHIWADI RERA REGN. NO: RAJ/P/2018/701</p>	<p>Under Construction</p> <p>R>TECH CAPITAL HOMES BEAWAR RERA REGN. NO: RAJ/P/2018/616</p>	<p>Under Construction</p> <p>R>TECH CAPITAL HIGHSTREET BEAWAR RERA Registration No.: RAJ/P/2018/803</p>	<p>75 STORES ALREADY OPERATIONAL</p> <p>R>TECH RETAIL</p>

Ongoing R-Tech projects are registered with RERA Authority and documents can be verified at www.rera.rajasthan.gov.in

COMMERCIAL • RESIDENTIAL • TOWNSHIPS • RETAIL

ALWAR • BEAWAR • BEHROR • BHIWADI • BIKANER • JAIPUR • JODHPUR • KOTA • NEEMRANA

OPERATIONAL PROJECTS



Actual View



Completion year: 2010
 Covered Space: 350000 Sq Ft
 Fully Occupied



Actual View



Completion year: 2016
 Covered Space: 535000 Sq Ft Appx.
 Total No Of Units: 963



Completion Year: 2011
 Covered Space: 200000 Sq Ft
 Fully Occupied



Actual View



Completion Year: 2017
 Covered Space: 940065 Sq Ft Appx.
 Total No Of Units: 756

RERA REGN. NO: RAJ/P/2017/075



Actual View

OPERATIONAL PROJECTS



Actual View

CAPITAL HIGHSTREET BHIWADI

Shops • Offices • Studio Apartments

Completion Year: 2016
Covered Space: 1050000 Sq Ft Appx.
Total No Of Units: 1849



Actual View

R>TECH CAPITAL GALLERIA ALWAR

Retail • Offices • Multiplex • Studio Apartments

Completion Year: 2018
Covered Space: 300019 Sq Ft
Plot Area: 5655 Sq. Mtr.
Total No Of Units: 534

RERA REGN. NO: RAJ/P/2017/073

CAPITAL HIGHWAY ARCADE BEHROR

Completion Year: 2016
Covered Space: 125000 Sq Ft
Total No Of Units: 207



Actual View

R>TECH CAPITAL GALLERIA NEEMRANA

Retail • Food Courts • Studio Apartment

Completion Year: 2019
Covered Space: 400000 Sq Ft
Total No Of Units: 636

RERA REGN. NO: RAJ/P/2017/074



Actual View

UNDER CONSTRUCTION PROJECTS



Actual View



Chikani, Alwar

Completion Year: 2020
 Spread Across: 85 Bighas
 No. Of Units: 4000
 Integrated Township

RERA REGN. NO: RAJ/P/2017/034



Artistic View



Completion Year: 2019
 Plot Area: 11890 Sq mtr
 Total No Of Units: 859

RERA REGN. NO: RAJ/P/2017/045



SIRSI ROAD, VAISHALI NAGAR, JAIPUR
 A PROJECT OF R>TECH & MNS

Phase - I: Completion Year: 2021
 Plot Area: 28454 Sq. mtr.
 Total No of Units: 2119

RERA REGN. NO: RAJ/P/2017/153



Artistic View



Completion Year: 2021
 Plot Area: 5251.70 Sq mtr
 Total No Of Units: 405

RERA REGN. NO: RAJ/P/2018/612



Artistic View

UNDER CONSTRUCTION PROJECTS



RTECH
**CAPITAL
HOMES**
BEAWAR

A JV Project of - R-Tech Buildtech LLP,
Gurubachan Singh & Others

मुख्यमंत्री जन आवास योजना - 2015
EWS एवं LIG हाउसिंग
Completion year: 2023
No. Of Units: 342 (Tower A,B & C)
RERA REGN. NO: RAJ/P/2018/616



RTECH
**CAPITAL
HIGHSTREET**
BEAWAR

A JV Project of
R-Tech Group & Gurubachan Singh & Others
Completion Year: 2023
Plot Area: 5167.87 Sq mtr
Total No Of Units: 459

RERA REGN. NO: RAJ/P/2018/803

RTECH
**CAPITAL
ARCADIA**

MAIN ALWAR BY PASS ROAD • BHIWADI

A JV PROJECT

Completion Year: 2021
Plot Area: 5493.70 Sq mtr
Total No Of Units: 637

RERA REGN. NO: RAJ/P/2018/701



RTECH
**CAPITAL
HIGHSTREET**
KOTA

Completion Year: 2024
Plot Area: 3444 Sq mtrs
Total No Of Units: 286

RERA REGN. NO: RAJ/P/2019/992



All the Documents related to the said project are duly uploaded on www.rera.rajasthan.gov.in and the prospective buyer(s) can verify the same.



Not the one to rest on its laurels the R-Tech Retail – A Retail wing of R-Tech Group continues to expand its horizons by entering into one of the fast growing retail segments by way of a mix of franchise model as well as launching its own retail brands



Our Associated Brands
